

BEST

(1) JORDAN

B is MALE

(2 or 3) JOKER

2 or 3 WILLY JACK

as of flower: Jan 9, 02

JORDAN: D, F, G, (B), I, C, E

JOKER: A, C

(the clone is alone)

WJ: L, J, (M), (S), E, H, C

alone

WJ (I) cloned Jan 10 rolled in "sunshine"

candidate: have clone and plant in 24hr

WJ: (I)

JORDAN: H, J... H is NEW clone! I also

JOKER: B, D, E, F, (S), H trefail

8 candidates: keep plant and grow clone!

9 including WJ "N" + Cuphoiso

WJ: (I) A
 JORD: (H) H
 JOKE: D F G E B H
 WJ: L (M) (S) E H C
 JORD: G F B C E D
 JOKE: A C
 WJ: K L A H M N O P Q R S T U V W X Y Z
 JORD: B D A T E G I F C
 JOKE: H I C E G B I A D
 NO: WJ (B) F
 NO: JOK (I)
 WJ: K O X
 JOKER: A G
 TREFOL: 3 B

alone RECLONED NEW CLONE trefail

WJ: E F J K R I

WJ: K O X
JOKER: A G
TREFOL: 3 B

this male is the only plant that compares to the D, F, B, JORDAN unless Jordan A or Joker(A) in a candidate if;

SIMILAR PLANTS: first group
JORDAN: DEF + A? (B) MALE clone
WJ: E M C especially E (A) MALE closer
JOKER: C (S) (I) C

vigorous (or good as any) best clones of WJ + D K + D (I)

best chance for MALE be best MALE IF...

24hr
cloned
not
set

WJ: I, G
 JOAD: (H) J
 JOKE: D, E, F, G, H, B *clone is clone*

 WJ: L, J, G, M, C, H, E (M) ALE 12
 JRDN: (D) E, F, G, I
 JOKE: A, C I ? also 3B

 WJ: (A) (D) (H) (J) (L) (N) 24
 JRDN: (B) (C) (E) (F) (G) (I) (J) (L) (N) 24
 JOKE: (A) (B) (C) (D) (E) (F) (G) (H) (I) (J) (L) (N) 24
 O NEW CLONE 2 ea (I) GLOWERS
 Old clone also
 needs to be cloned
 RUNT
 XTINKT: WJ: B, F (N) not yet
 JORDAN:
 JOKE: I

The best and quickest way to determine sex by 12 weeks, look about 12 weeks, look about magnification but there, where the those spurs is where you'll find the whereas the female will be a tiny p themselves first. Grape-like cluster numbers. To the novice they tend to you see.

Marijuana outdoors will grow in the start to get shorter, until the night time when you would switch to a bl will start to form growing larger and

When to harvest your prized beautie have planted. Given that all of those hairs are now starting to wither and di

st 8 weeks old, and You may need "spurs". At the base of de-shaped, on a tiny stalk, ins, the males will show ncreasing in size and d pot, yank out any male

er solstice. The days then to flowering. This is the with will stop and the buds

, and the strain that you ady. The fuzzy white The calyxes, where the

seeds would be, are swollen, and the resin glands covering everything, are erect, full and are clear or a slight amber color. A milky color tells you that they are not quite ready. You want to avoid frost and many wet cold days in a row near the end of your season. Frost will kill the plants and the cold, wet will promote your buds to rot. If the weather has turned ugly and isn't expected to change, it's better to cut them down early than too late. For buds that have been pollinated, peak potency and maturity is considered to be when the seeds break through the bracts, some even falling. How you actually cut your buds depends on a few things as well. If you have few plants in your flower garden, you might cut off buds as they reach maturity. If you have a stealth operation, you had better cut down the entire plant, bag them and git!

STORAGE

Once you've reached that point of perfection in the cure, it's time to seal it up to protect those delicate resin glands. Oddly enough, three of the elements that helped grow your buds, heat, air and light, now become the enemy to your stash. Seal your buds in airtight containers (zip-lock bags, Tupperware or vacuum sealed) and store in a cool, dark place. Stored this way, the pot will retain its potency and flavor well after you've forgotten where you buried it.

THE GOLDEN RULES OF GROWING

1. Choose a strain that is suited to your environment, personal taste and expectations.
2. Provide as much quality light as you can.
3. Transfer the air regularly.
4. Check and balance the Ph of any water you add.
5. Provide adequate amounts of water. Do not over-water.
6. Provide adequate amounts of nutrients. Do not over feed.
7. Flush your system or pots regularly.
8. Maintain consistent temperatures and lower the humidity for flowering.
9. Stop feeding for the final 2 weeks of flowering.
10. Use a method of growing that suits your available time and space.
11. Don't grow your plants too tall before flowering.
12. Be meticulously clean.
13. Harvest at peak potency.
14. Dry and cure slowly.

BEST PROSPECTS

best clones:

(1) JORDAN; D, F, **B** (A) clone only; best chance for MALE
is. would be best MALE IF...

B is MALE

(2 or 3) JOKER: **A in Y** (good clone) also B, I

2 or 3 WILLY JACK: (MALE) plant looked very vigorous (as good as any)
A clone only. **I, A, L** best clones of WJ + D
K + D (X)

as of
flower: Jan 9, 02

JORDAN: D, F, G, **B**, I, C, E

JOKER: A, C

back to 24hr

WJ: L, J, **M**, N, E, H, C

alone

this male is the only
plant that compares to
the D, F, B, JORDAN's
unless Jordan A into Y + L
Joker(A) in a candidate if;

SIMILAR PLANTS: first group
JORDAN: DEF + A? **B MALE** clone
WJ: EMC especially E **A MALE** closer
JOKER: C **clone**

WJ (I) cloned Jan 10 rolled in "sunshine"

candidates: WJ: **I**
I have clone and plant in 24hr
JORDAN: H, J... H in NEW clone! I also
JOKER: B, D, E, F, **G**, H **trifol**
8 candidates: keep plant and grow clone!
9 including WJ "N" + Cuphoiss

INVENTORY

MALE PLANT 2 ea 3B regrow Y

1 WJ: plants (G) I, N, Jordan: H, J, Joker: G, H, F, D, B, E

2 clones (I, H, L, C, D, N) / (J, G, I, F, E, C, A, F, B) / (E, H, G, A, B, F, C, J, D)
A, K, (J)

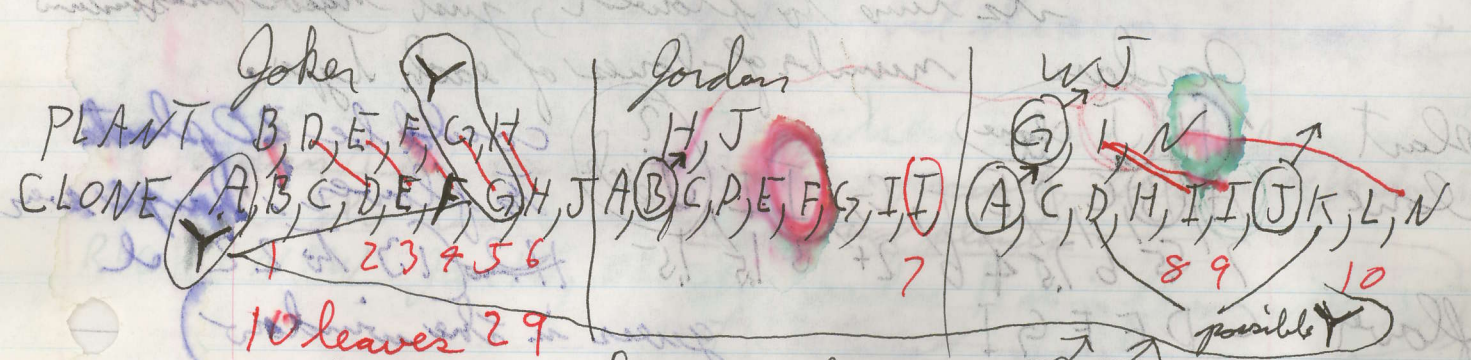

10 females and the 2 males WJ (G) (J) will be cloned again by them (don't need full growth)
12

OVER

in the next 2 weeks to 4 weeks these plants will have all kinds of clones on them so what's to worry?

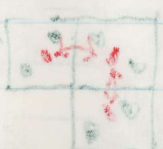

WJ = WJ
J = Joker
D = Jordan

INVENTORY

MALE PLANT 2 ea 3B regrow Y

1 WJ: plants (G) I, N, Jordan: H, J, Joker: G, H, F, D, B, E

2 clones (I) H, L, C, D, N, J, G, I, F, E, G, A, F, B, E, H, G, A, B, F, C, J, D, A, K, (J)

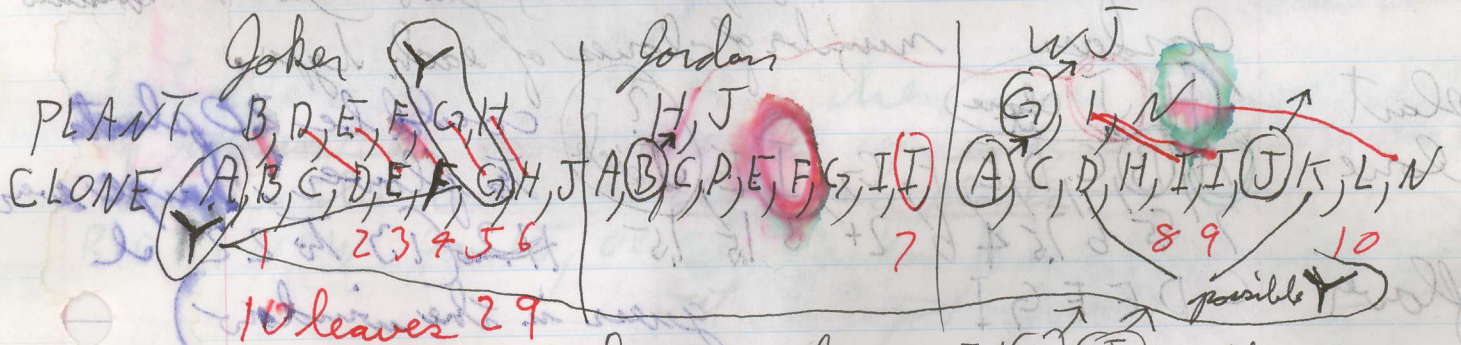

10 leaves 29

10 females and the 2 males WJ (G) (J) will be cloned again by them (don't need full growth)

12

OVER

in the next 2 weeks to 4 weeks these plants will have all kinds of clones on them so what's to worry?

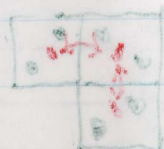

WJ = 2W
J = 1W
D = 1W

To be cloned

WORK SHEET

F is extinct

16
 plant Jaker
 clone B, D, E, F, G, H, Y
 flower A, C

Y 2" 4" ? 2+2 4 2 2

since I have time:
 anything that can be
 cloned (preferably off bottom struts) when
 its time to flower; just have maximum

18
 plant Jordan
 clone H, J clone it
 flower C, D, E, F, G, I

7 5.5 6 7.5 4 6 2+ 3 1.5 1.5

J sick

number of clones of each type.
 could be 20 plants
 to flower; large ever
 H and I 3 to 22 cl
 guess in the window)

3

18
 plant Wally Jack!
 clone G, I, M??
 flower C, E, H, L, M

7.5 4.5 3.5 3 5 2 3 6 5 ?

regrow

B, F EXTINCT

I could do fine with
 13 @ 2" & going in and
 tie down E, M regrow

$10 + WJ:N + WJ \rightarrow G, J$

() Euphoria

Jordan = D
 Jaker = K
 WJ = W



North

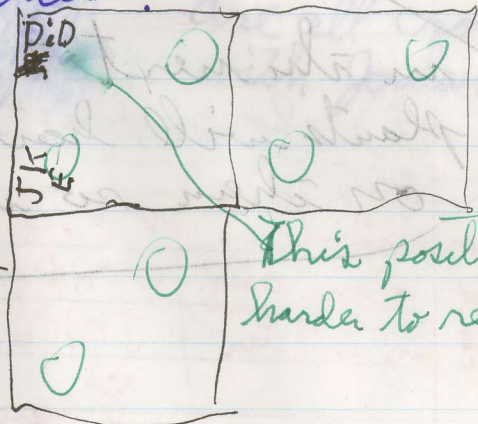

This position is harder to reach

MALE PLANT

WJ: (J) (G) (A)

Jan 16, 02
J is good clone also

JORDAN: (B) in flower, clone also good clone one of largest
out of flower (destroyed) Jan 21, 02
(C) everything (female) fertilized

WJ: A is still the one I should mate to Jordan D, F, + A if not male

I tracked the plant way back but the clone is good +

it's NOT
But if Jordan A is MALE then those 3 jords are IT.

If Jordan A is male it should especially be bred to Jordan D
they are the two 16 best clones and plants

RIGHT NOW Jan 15, 02 the Jordan B is in flower with (F) +
out (destroyed) Jan 21

need to grow 20%
and get flow
the plants
the plants
plants are
grow the plants
four plants
to flower
system figured out about 3 weeks from Jan 23
OVER

Jordan's H needs to be closed

PALE PLANT

WT: J (A) (C) (T) (W)

JORDAN: (B) in flower, close down and close out leaflet
out of flower (but not) Jan 21/02
(eventually) female) for this

WT: A is still the one & should mate to Jordan's F. A. if not mate

I tracked the plant way back but the clove is poor

Right now Jordan's F. is in flower
but if Jordan's A. is not in flower
the plant is male & should experience
they are the last of the clove
+ Right now Jordan's F. is in flower
out of flower (but not)

Jordan = J
John = K
WT = W

This position is
hard to reach

Candidates for flower (room 1/2 empty)

clone and plant in gro -

that is I have
room for say 15
if they are single
stalk and I call

WT: I (J) (G)

JORDAN: J, (I new clone)

JOKER: B, D, E, F, H G is trefoil

I can use G and save for trefoil also !!

a. fan
Euphorbia

one of these (I) I think ~~there~~ has 2 clones?

SO about 8 + 5 or 10 Euphorbia (to call after flower)

about 15 plants to grow

BUT WAIT; get into this, you need to get these
plants ~~into~~ up to 2' in gro. and that by

then the flower room is empty so I really
need to grow 20 to 25 plants up to 2'
and if I get flower room empty I can grow in
there so the sooner the better and some of

- I can start 2 week plain water now,
the plants remaining in flower you know.

I NEED to organize the largest
plants so if clone is big fine but if not
grow the plant (minimize diameter) or use
fewer plants if there are very many mamas
to flower. I need to get ~~an~~ aeration
system figured out. about 3 weeks from Jan 23

OVER

NEXT ROOM FULL:

as far as pollinating; we used Jordan B so...

Willy Jack (A) is set with Jordan DFA if not male

that leaves: WJ (J) (G)

I say use em both (grow 'em out and flower 'em and see which is best) (actually don't not sure both are male) could be a mistake I don't think so but hey

Jan 23 I have 15 ready clones but some are alone. By ready I mean the clone has some growth 3 or 4 inches but ready to respond if given preferred light (center section).

ES - reform Jordan & took the Beijing night
OVER

19 ed

SOUTH PAN

XX PLANT CLONE

Jhr: H	Big	✓ 12
Jhr: F	Big	✓ 13 1
3A:	? from flower	
Jdm: C	H; W 6"	✓ 14 5
Jdm: H	3am BIG -	✓ 15 8
Joker: D	BIG: stop	✓ 16 4
WJ: I	ONE BIG am	✓ 17
Joker: B	3 Big am	✓ 18 4
Jdm: J	2 Big	✓ 19 4
WJ: A	7"	✓ 20 3
Jdm: A	7"	✓ 21
Jdm: F	6"	✓ 22
Jdm: B	5 1/2"	✓ 23
WJ: K	6"	✓ 24
WJ: N	2 am	✓ 25
Joker: E	2 Big (small)	✓ 26
WJ: J	3"	✓ 27 8
3B:	? from flower	
Jdm: D	7 1/2"	✓ 28 P

NE PAN 20 to 28 plants that can be big enough to clone before going to flower (even if grown in flower room)

22 each

NW part

PLANT	CLONE	CONDITION
WJ condition	good condition	

1	5"	WJ: I
	2"	Jok: E
2	3"	WJ: H
3	5"	WJ: L
	2"	Jok: H
	2"	Jok: G
	2"	Jok: A
4	4 1/2"	WJ: C
5	3 1/2"	WJ: D
	2 +	Jord: G
6	4"	Jok: B
7	4"	Jok: F
	1 1/2"	Jordan: I
	? +	Jok: C
	1 1/2 +	Jordan: J
8	3"	Jordan: I
	? not good	WJ: N
9	4"	Jord: E
	2"	WJ: I

BIG 2 arm 10

2" +

x prony but healthy (been blocked) WJ: G

11

get clones from:

7

Feb 12, 02

To save 30 clones

1 of each hybrid

flower the rest or most about 20

2 Jaker: C, A

3 Jordan: H, J / A,

3 WJ: N? / D, K, (M?)

2 regrow E, M from flower

good idea Take a clone to keep option (I if alone) was 2 clones

marginal 8"

since there is only 2 large and maybe 3 other good Euphorbia left I should have room for 18 ± clones

too small for anything but save Feb 15, 02

23

WJ: H, N, C, I, L, G, J, A, I, N, D left out only 27!

Jordan: E, I, J, I, G

Jaker: G, C, H, E, A, D, B, A

15 WJ: K, I, Jordan: C, B, F, H, D, A, J, I

Jaker: B, F, G, H, E, D

must clone

WJ: B, F, D, E, F

I: Jaker

1 Top Epsom 87 Mg 1155

1/2 Top 44 Mg (575)

1 top PgpP 176 Ca + 1415
1985

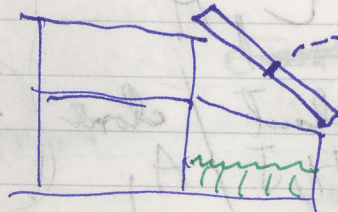
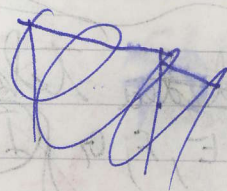
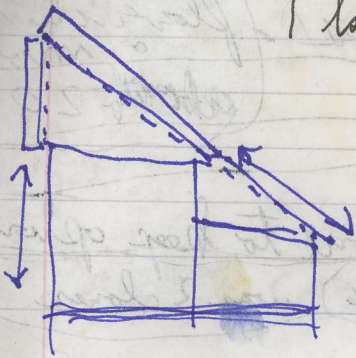

282
283

Call Sebastien fert

a 50% anhydrite

BFA MACROTECH

101 ELLIOT AVE West

SUITE 110

SEATTLE Wa
98119

800-426-5989

yes
PHARM CHEM
lack of exp

WECO SPOKANE

727, 4500
WIBER ELLIS } ROB

Sebastien Scott
452-6425

PH Test
mud - body
infect? make good at
infect about individual - collection
phages - metaphase

- in flower now 13
- to flower 15
- to SAVE (clones now) 21

FEB 16, 02

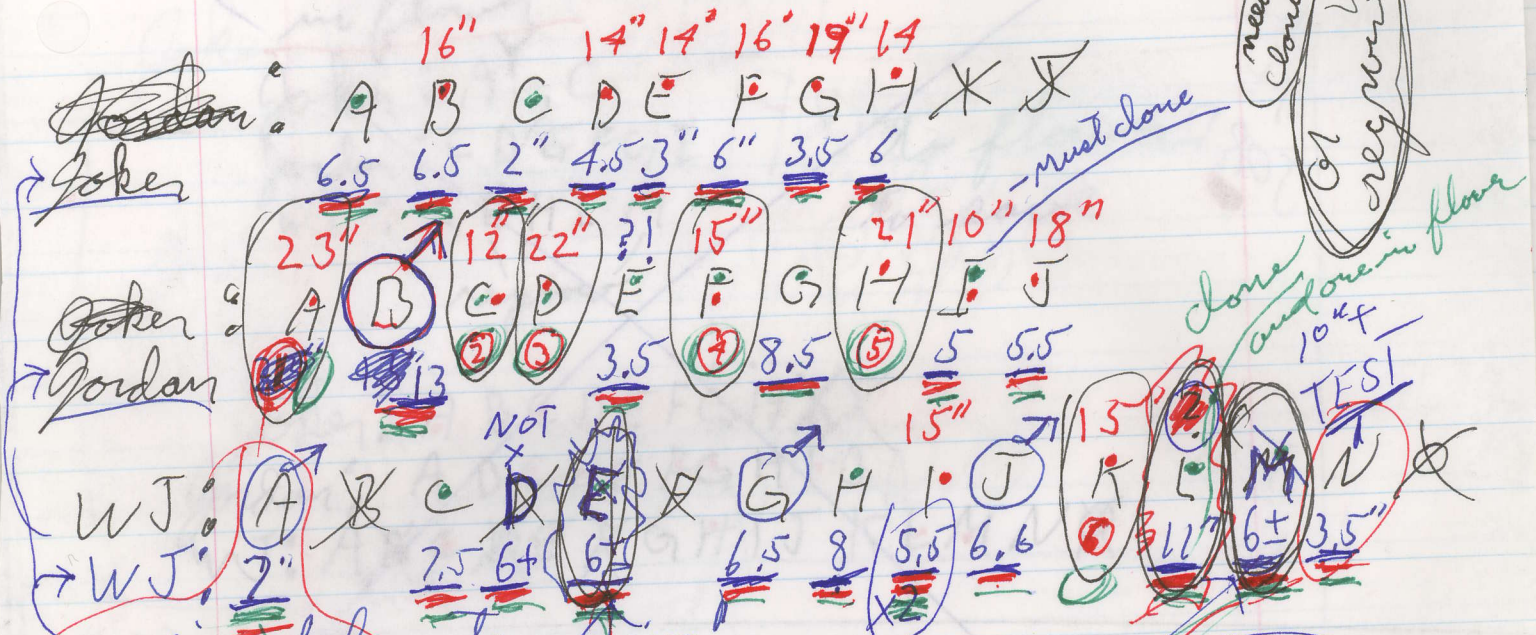

size before trimming.
 missed this one
 2 ea 3 B = 27 total

one of these may be mislabeled
 one is missing (or 2)

OF 15 to flower at least 3 and maybe 6 ♂ male?

Feb 18 WJ: E, M back to grow for regrow

22 ea leaves room for 9, I need 6

Feb 20, 02 took clones of WJ: K
 Jordan: A, C, D, F, H

Joker = 8
 Jordan = 10
 WJ = 12

if all survive I have 30 hybrids
 left of 35

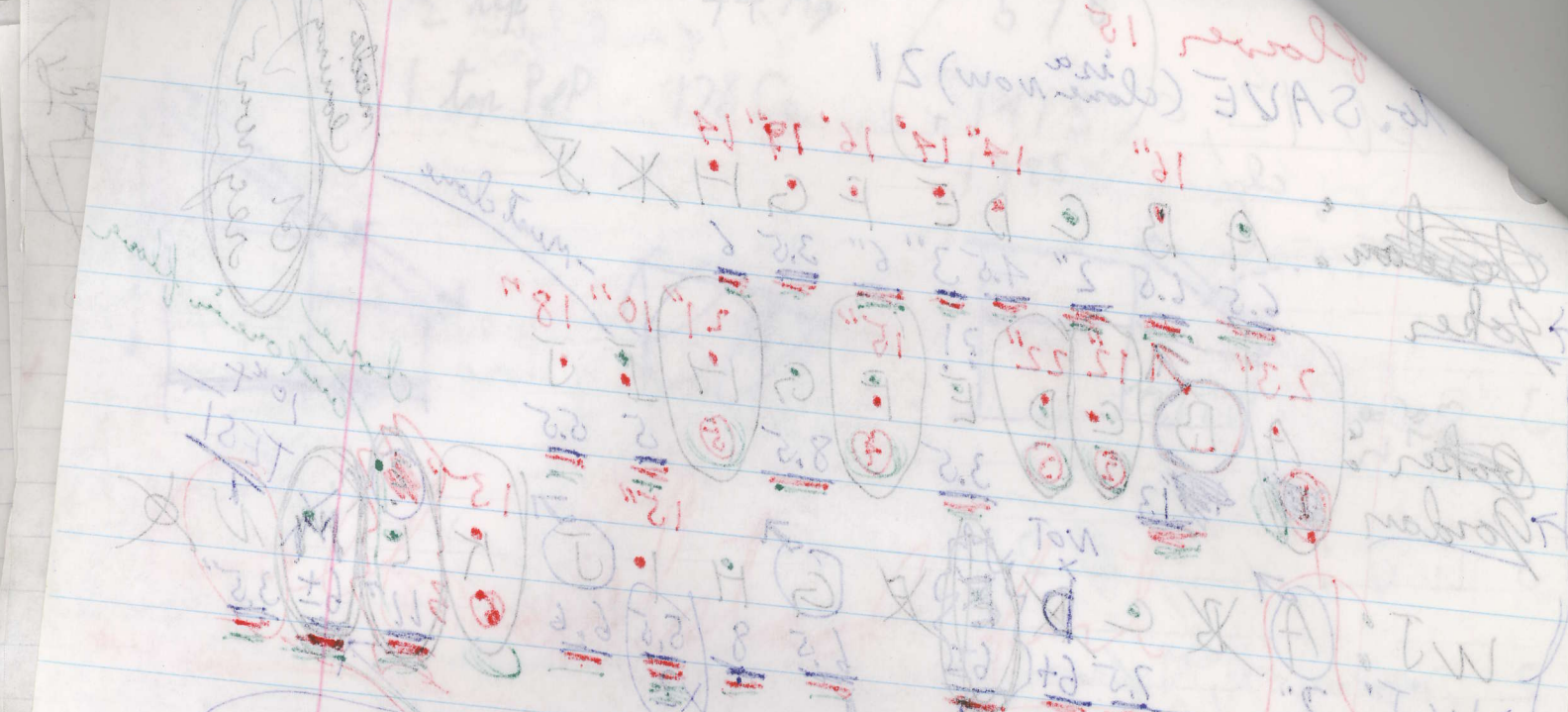

one of these may be
 uncalibrated
 one in mining (S)

5 sec 3 B = 5.1 total
 raised this one
 size before

at least 3 and marked
 anhydrite
 07/15 to flower

WT: E M look to go for region
 Feb 18

53 or lower room for P, B, and S

WT: K
 H, F, A, G, J, I

WT = 15
 garden = 10
 if all uncalibrated
 30 uncalibrated

52-6425

May 25, 02
flowering

clover now

~~in flower~~

Joker: A, C
Jordan: C, D, E, F, G, I
WJ: C, E, H, L, M
regrow

To flower
to save

Joker: A B C D E F G H I J
Jordan: A B C D E F G H I J
WJ: A B C D E F G H I J K L M N O

March 13, 02

variable clover

2 ea 3 B

WJ: C, I, J, K, A, G, L, D, N, H,
Jkr C, F, D, G, I
Jordan: D, A, C, F, G, J

? MALE
K, A, G, L, D, N, H,
G, I
MALE

MALE
Joker: H
WJ: K
Joker: L

seeds left of 43 (with widow)
what should be checked for fruit

Joker B. purple calyx X, G

H
JORD

JORP F

JOR H

JOR E

JOR I
W J
H

Mar 25, 02
flowering now

clones now

Joker: $\overset{\uparrow}{\text{B}}$ $\overset{\uparrow}{\text{C}}$ $\overset{\uparrow}{\text{D}}$ $\overset{\uparrow}{\text{E}}$ $\overset{\uparrow}{\text{F}}$ $\overset{\uparrow}{\text{G}}$ $\overset{\uparrow}{\text{H}}$

23 ea + 9 or B
17 females
? Males with

Jordan: $\overset{\uparrow}{\text{A}}$ ~~$\overset{\uparrow}{\text{B}}$~~ $\overset{\uparrow}{\text{C}}$ $\overset{\uparrow}{\text{D}}$ $\overset{\uparrow}{\text{E}}$ $\overset{\uparrow}{\text{F}}$ $\overset{\uparrow}{\text{G}}$ $\overset{\uparrow}{\text{H}}$ $\overset{\uparrow}{\text{I}}$ $\overset{\uparrow}{\text{J}}$

good! green female first batch

WT: $\overset{\uparrow}{\text{A}}$ $\overset{\uparrow}{\text{C}}$ $\overset{\uparrow}{\text{G}}$ $\overset{\uparrow}{\text{I}}$ $\overset{\uparrow}{\text{J}}$ $\overset{\uparrow}{\text{K}}$ $\overset{\uparrow}{\text{L}}$ $\overset{\uparrow}{\text{N}}$

Y 3B
Y Joker G
Y WT: K
Trefoil
very precocious flowering possible

PROGRAM

grow both 3B clones up and breed one to Joker: G and one to WT: K

Bred to Jordan: B otherwise extinct Mar 25, 02

WT: $\overset{\uparrow}{\text{E}}$ $\overset{\uparrow}{\text{H}}$ $\overset{\uparrow}{\text{M}}$
Jordan: $\overset{\uparrow}{\text{E}}$
Joker: $\overset{\uparrow}{\text{A}}$

= 5 ea somewhat saved

= 29 total saved genes of 35, 33 germinated

also there is still ? seeds left of #3 (white widows) that should be checked for Trefoil

Joker $\overset{\uparrow}{\text{B}}$: purple Calyx X Joker G?

W.J. (A)

March 27, 02

March 25, 02
MALES

Joker: G, H
Jordan: B extinct (bred)
WJ: K, A, G, J
2 ea

5 ea Mar 5, 02

clones

Jordan Joker: B, C, D, E, F,
Jordan: A, E, C, D, D, F, G, H, I, J
WJ: C, G, I, J, L, N

19 ea Mar 25, 02

Jordan B+
~~24 left of 33~~
what is in flower

Joker G very precious flowering

IN FLOWER 13 ea + 4 Euphorbia ?

Joker: B, D, E, F, G, H
Jordan: A, C, D, F, H, I, J
WJ: I, N

good quantity but...
Joker E smells bad
Jrdn H smells good

Joker B is purple
Jrdn J has seeds
Jrdn C has seeds
Jordan D is GOOD
WJ: N is good lasts longer

3B 2 ea Clones

WJ: N, L, J, G, I, C, K, K
Jordan: J, G, D, C, F, A, S, I, H, D
Joker: H, C, G, P, D, E, H, B

Eriphonia 8.4
 2 = 8.5
 Jordan C 3.5
 WJ: H 3.5
 WJ: L 2.5

WJ: E
 WJ: M

Jordan: F
 Jord: E

M2: V
 Jordan D
 Jordan C
 Jordan B
 Jordan H
 Jordan E

IN ETOMEB 13 20 + 4 20

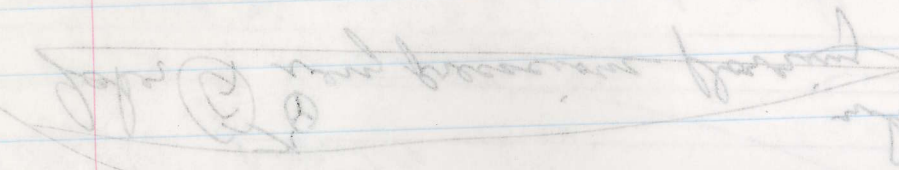

+ B
 C
 D
 E

M2: C
 Jordan: H
 Jordan: B
 Jordan: C
 Jordan: D
 Jordan: E

50.5

M2: K
 Jordan: B
 Jordan: H

50.2

50.25

NOW " March 27, 02
NEEDED IN GBO ROOM

1. Breed 3 Euphorias

clean gravel
put 20 oz cups in 2 litre jug

clean pans

rinsed plants

New formula (fresh)

~~use~~ baffle on air in (reflector)

bigger pulley on fan (same on motor)
or use smaller fixed pulley on motor
and control air by restricting flow!

I could restrict flow quite a
bit now

leave ~~BT~~ 3B clout (large one) in 12 hr

? SAVE Bag of (Jaker, G) pollen for
a couple of weeks after pollinating (save
a branch on the plant) but then it
has to open bag upside down but if I
do it all in back room? maybe eh?

FLOWER ROOM 4 gallon ea

2 ea gravel

8 ea moss (2 sphagnum) $\frac{1}{2}$ vermiculite

15 ea $\frac{1}{3}$ Moss $\frac{1}{3}$ vermiculit $\frac{1}{3}$ perlite
 $\frac{2}{5}$ moss $\frac{1}{5}$ $\frac{1}{5}$ $\frac{2}{5}$

25 x $\frac{1}{2}$ ft³ say 12 ft³ about 7" deep maybe 8"

8 ea ~~new~~ and used super soil and sunshine
 4 ft³

2.0 gallons water $\frac{1}{8}$ top + 18-18-21 each

1 top micro each

10 to 15 cups of Dolomite mixed in soil

actual total

2.5 ft³ ca moss

3 ft³ perlite

3 $\frac{1}{2}$ ft³ vermiculite

2 \pm ft³ getting soil new

maybe 2 \pm ft used Jordan

18 ft³

compare 17

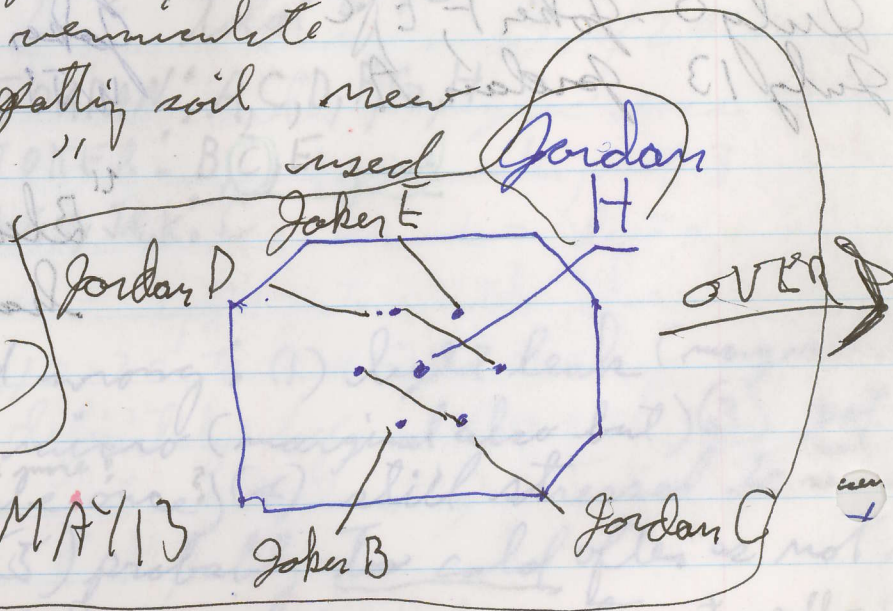

To flower MA/13

Joker B

Jordan C

Cuprous

MAY 14, 02

MAX 12

July 7-5

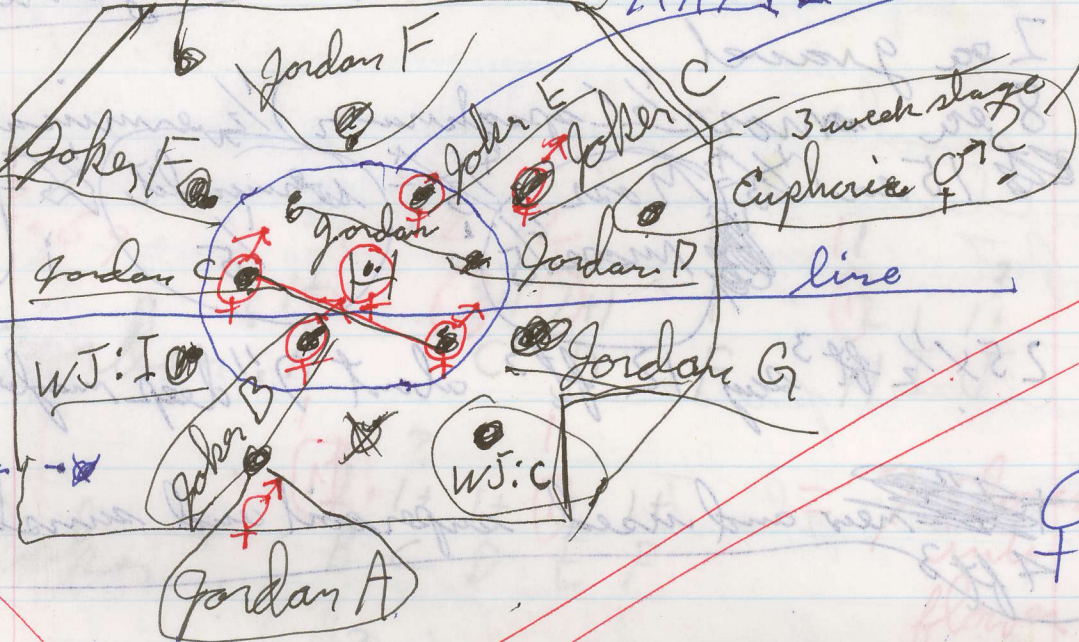

3 week stage
Euphrasia ♀

line

WJ: I

WJ: C

♀

	1	2	2	1	1	1
Jordan:	A	C	D	F	G	H
Joker:	B	C	E	F		
WJ:	C	I				

July 1: Jordan H

harvest

unused this time: Jordan I J

July 5 Joker F, E, C

Joker D

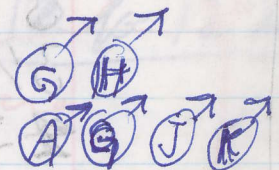

July 13 Jordan A

WJ: L N

"Blueberry" in 2 litre jug
has shale in buds

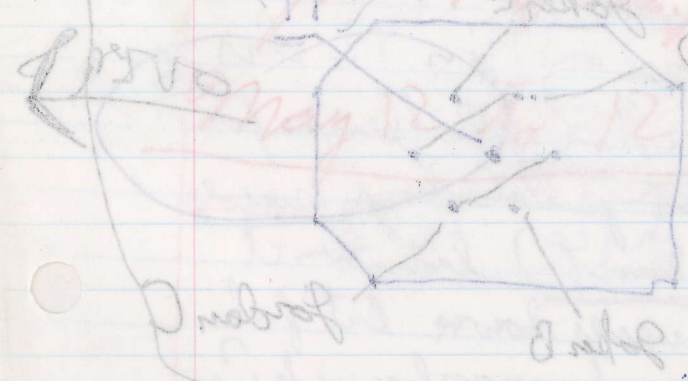

Harvest July 5, 02

June Jordan H (from center of room) — best to here

Joker F definite ♀ male parts no seeds

Joker E + C (one seed in C) both ♀

July 15 BB in two litre (probably Jordan)

July 14 Jordan A ♀

July 17 south Jordan C 8oz wet

19 North Jordan C

20 So Jordan D

21 5 Euphorias

24 everything east of line is out (leaves) Jordan: G, Joker: B
one Euphorias NORTH ~~WJ: I, C~~ WJ: I, C

27 everything out

must have been Jordan: A that smelled (mint)

aug 4, 02 threw out all but:

Jordan: D, F, A, H, G, C, total of 10 ♀

Joker: B, E, C,

WJ: C

JORDAN: A, C, D, F, G, H

JOKER: B, C, E good

Willy JACK: C

SURVIVE

4 things I did wrong: (1) light leak (marginal but) (2) inadequate micro (marginal also but) (3) got too hot (maybe more?) (4) still stressed to ^{not} necessarily begin with? (5) probably too cold after as not.

ph OK maybe could have used more water not really!

Aug 4, 02 SURVIVING (cleaned house)

Jordan: A, C, (D), F, (G), H Clones A, C, F, H, (I)

Joker: B, (E)

WJ: C (good)

alone

so I actually have 7 Jordans left

The plan to refill flower room

take 20 to 25 clones as soon as possible
then a week later take 20 or 25 more
then maybe a week later again but

two sets should do it. 2 weeks done
3 weeks grow 2 weeks preflower

24, 20 or cups would do it. If cloned
in 2 or 3 days they would flower about

flower: 10 of September.

Maybe wait a week and go
with 24 best clones I don't think

I have room for 2 or more sets of 24

If I make clones later maybe use
30 to 35 and grow 1-2 weeks, not 3.

SAY: Aug 20 plant 30 clones \pm 2 weeks = Sept 4

grow ~~flower~~ 1-2 weeks = Sept 10 to 20th then

preflowers Sept 10-20 to 24-30 = crop

end of NOV. definitely before XMAS

Aug 5, 02 clones that were cloned July 5 \pm

Jordan: A, C, F, H, I

9 including WJ "N" + Cuphoriss

cup A, 05
Jordan: A, C, F, H, I
class A, C, F, H, I
W.C. good

as I actually have Jordan left

The plan to refill flower room

take 2 to 25 class or room as possible
then a week later take 20 or 25 more

then another week later again but this
time take should be 10 or 15 more class

2750 of cups would be it. If class
in 2 or 3 days they would flower about

10 of September.
Maybe wait a week and go
with 154 best class. I don't think

of have room for 5 or more sets of 27
if I make class later maybe use

30 to 32 and grow 1-5 weeks next 3,
2A: one 20 plant 30 class = 5 weeks = Sept 1
grow for 1-5 weeks = Sept 10 to 20th in

preparat Sept 10-20 to 27-30 = cup
end of Nov. definitely before XMAS

cup 2 or class that were class Sept 25
Jordan: A, C, F, H, I